

#hybrid stepper motor 13001A

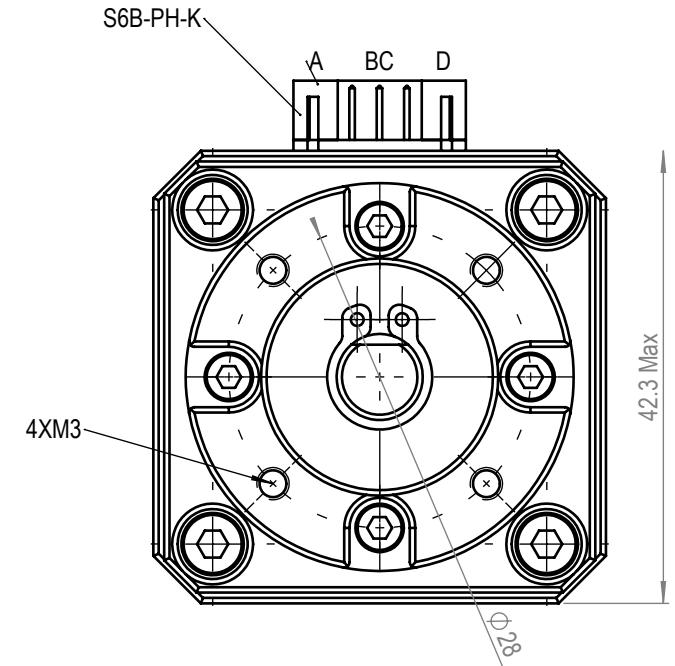
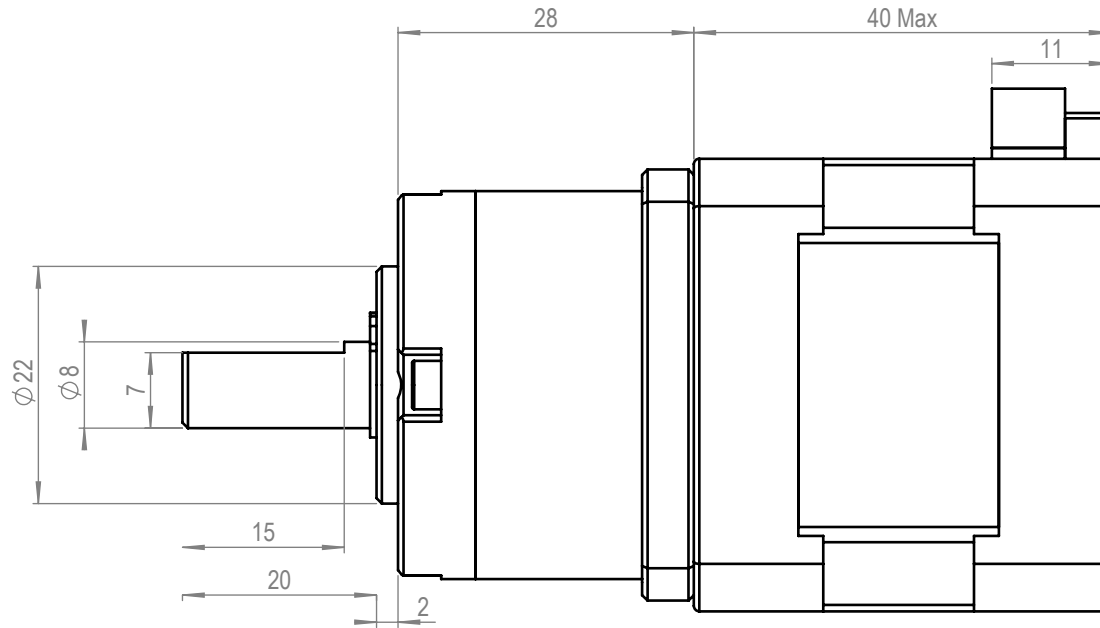

Specifications

Step Angle	1.8°±5%
Number Of Phase	2
Rated Voltage	2 V
Rated Current/Phase	1.2 A (Peak Value)
Holding Torque	320 mNm (motor)
Detent Torque	
Phase Resistance	1.7Ω±10%
Phase Inductance	4.5 mH±20%
Insulation Resistance	100MΩ min. (500V DC)
Rotor Inertia	57 g·cm ²
Weight	240 g (408 with gearbox)
Insulation Class	Class B

Gear Specifications

Gear Ratio	1:5,18

NAME	Nema17 40+28mm Geared Stepper Motor 20mm D-shaft
TYPE	Hybrid Stepper Motor
Retail SKU	13001A
Production SKU	13001