

HOW TO Install an IDGA on an IFS extruder for Prusa Mini

Difficulty **Easy**
Steps **10**
Time Required **5 to 10 min**
Sections **1**
Related Guides **[IFS on Prusa Mini](#)**



PRODUCT PAGE



INSTRUCTIONS GUIDE

This guide is designed to be a reference manual for the installation of an IDGA Retro-fit Set on an IFS Extruder for Prusa Mini. Follow the instructions below or, if you prefer to watch a YouTube video with the same instructions, use the provided link or the YouTube icon to the right:

<https://youtu.be/E7A694bDrcM>



01

Remove the IFS extruder from your printer and unpack the new IDGA kit.

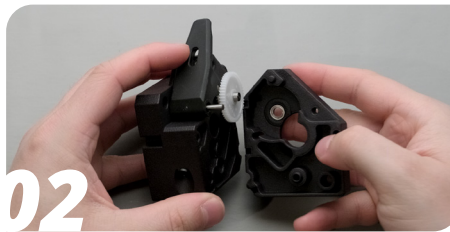

02

Pull apart the front body from the rear.



03

Pull out the existing shaft and primary gear.

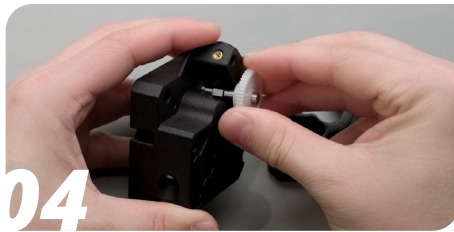

04

Take out the old ball bearings from the rear and front body.

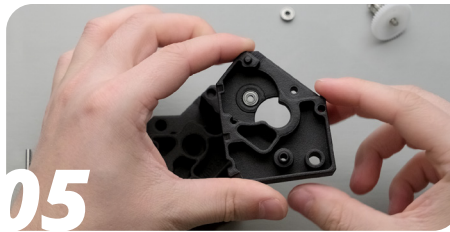

05

Place the new ball bearing into the rear part of the body.

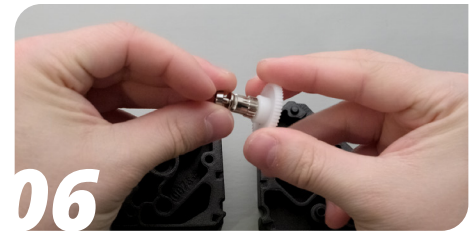

06

Place the other ball bearing on top of the new IDGA shaft.

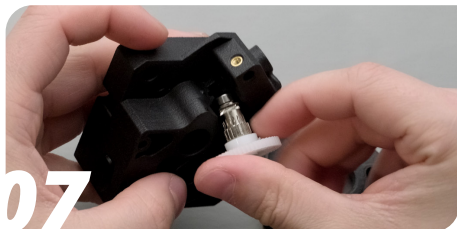

07

Insert the IDGA shaft to the front body.

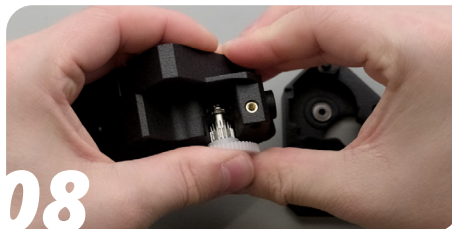

08

Press firmly to secure the ball bearing into its socket.

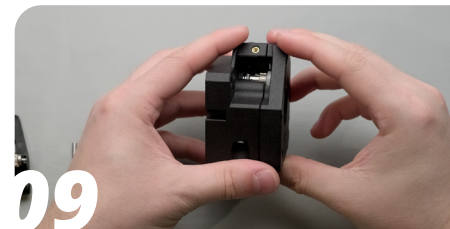

09

Reassemble the extruder.



10

Reinstall the IFS extruder in your printer.

RELATED GUIDES

If you need a guide to unistall or reinstall the IFS extruder in your printer, follow the link bellow:

<https://www.bondtech.se/product/ifs-extruder-for-prusa-mini/>

IT'S DONE! TAKE GOOD CARE OF IT

Every 6 months, or sooner if you have a higher than 15h per week average usage, perform the following maintenance operations:

1. With a tooth brush and alcohol:
 - a. Clean the IDGA & secondary drive gear
 - b. Clean the needle bearings
 - c. Clean the secondary shaft
2. With a fine brush and lubricant:
 - a. Apply a moderate amount of lubricant to the spur gear teeth of the drive gears, ensuring that excess lubricant does not spill over and cause any other parts to become greasy
 - b. Lubricate the needle bearings
3. With compressed air:
 - a. Blow the housing plastic parts to remove dust & dirt particles

HOW TO GET HELP

We are available to help you with any questions or issues you may have. Simply go to our website where you can access our customer support and send us your questions or follow the provided link:

https://www.bondtech.se/contact/#tab_technical-support-requests

